

**NEW!**

## Fulcrum Winch Series

5300 to 45600 lb (2409 to 20727 kg) capacity



**The new Fulcrum “E” series electric winches are designed to meet or exceed North American ANSI / ASME B30.7 standards while providing optimum performance in a rugged, safe, and versatile package.**

IR has combined over 70 years of electric winch manufacturing experience with input from a diverse group of endusers, riggers, and regulatory officials, to determine the design criteria for the new Fulcrum series of winches. Based on industry requirements to maximize safety, versatility, and reliability the Fulcrum “E” series is available in two basic configurations: “EP” for pulling applications, and “EL” for lifting applications. An extensive array of options further enhances the Fulcrum’s flexibility while its 5:1 design factor and **two year warranty** is your assurance of safe, dependable operation for the most demanding applications worldwide.



EP45600 (20 ton Electric Fulcrum Winch)

### Standard features

- Meets or exceeds ANSI / ASME B30.7
- Lifting models with 18:1 D/d ratio (per ANSI / ASME B30.7)
- Pulling models with 15:1 D/d ratio (per ANSI / ASME B30.7)
- 5:1 design factor
- Winch motors are high torque design, rated for continuous duty totally enclosed fan cooled (TEFC)
- All worldwide voltages
- Wide selection of standard gear ratios and line speeds
- Automatic motor disc brake
- Fully enclosed, 95% efficient, planetary gear boxes
- Underwound or overwound cable take-offs
- Variable mounting configurations (inverted, side, etc.)
- **Two year warranty**
- Hydraulic and Man Rider™ models available on request

### Specifications:

#### for pulling winches at 15:1 D/d ratio

| Frame | Rope size |      | Winch 1st layer rated load |       | Drum diameter |     | Flange diameter |      | Std. drum length |     | No. of layers | Capacity std. drum |     | Standard min. drum length |     | Standard max. drum length <sup>1</sup> |                   |
|-------|-----------|------|----------------------------|-------|---------------|-----|-----------------|------|------------------|-----|---------------|--------------------|-----|---------------------------|-----|--|-------------------|
|       | in.       | mm   | lbs                        | kg    | in.           | mm  | in.             | mm   | in.              | mm  |               | ft                 | m   | in.                       | mm  | in.                                    | mm                |
| 3     | 1/2       | 13   | 5300                       | 2409  | 8.625         | 219 | 17              | 432  | 18               | 457 | 7             | 768                | 234 | 18                        | 457 | 42                                     | 1067 <sup>1</sup> |
| 3     | 9/16      | 14   | 6700                       | 3045  | 8.625         | 219 | 17              | 432  | 18               | 457 | 6             | 577                | 176 | 18                        | 457 | 42                                     | 1067 <sup>1</sup> |
| 4     | 5/8       | 16   | 8200                       | 3727  | 10.750        | 273 | 22              | 559  | 24               | 610 | 8             | 1216               | 371 | 18                        | 457 | 48                                     | 1219              |
| 4     | 3/4       | 19   | 11700                      | 5318  | 10.750        | 273 | 22              | 559  | 24               | 610 | 7             | 896                | 273 | 18                        | 457 | 48                                     | 1219              |
| 5     | 7/8       | 22   | 15900                      | 7227  | 14.000        | 356 | 28              | 711  | 24               | 610 | 7             | 962                | 293 | 18                        | 457 | 48                                     | 1219              |
| 5     | 1         | 25.4 | 20600                      | 9364  | 14.000        | 356 | 28              | 711  | 24               | 610 | 6             | 713                | 217 | 18                        | 457 | 48                                     | 1219              |
| 6     | 1 1/8     | 29   | 26000                      | 11818 | 16.000        | 406 | 34              | 864  | 24               | 610 | 7             | 877                | 267 | 18                        | 457 | 48                                     | 1219              |
| 7     | 1 1/4     | 32   | 31900                      | 14500 | 20.000        | 508 | 38              | 965  | 24               | 610 | 7             | 946                | 288 | 18                        | 457 | 48                                     | 1219              |
| 7     | 1 3/8     | 35   | 38400                      | 17455 | 20.000        | 508 | 38              | 965  | 24               | 610 | 6             | 721                | 220 | 18                        | 457 | 48                                     | 1219              |
| 8     | 1 1/2     | 38   | 45600                      | 20727 | 24.000        | 610 | 45              | 1143 | 30               | 762 | 6             | 974                | 297 | 24                        | 610 | 60                                     | 1524              |

#### for lifting winches at 18:1 D/d ratio

| Frame | Rope size |      | Winch 1st layer rated load |       | Drum diameter |     | Flange diameter |      | Std. drum length |     | No. of layers | Capacity std. drum |     | Standard min. drum length |     | Standard max. drum length |                   |
|-------|-----------|------|----------------------------|-------|---------------|-----|-----------------|------|------------------|-----|---------------|--------------------|-----|---------------------------|-----|---------------------------|-------------------|
|       | in.       | mm   | lbs                        | kg    | in.           | mm  | in.             | mm   | in.              | mm  |               | ft                 | m   | in.                       | mm  | in.                       | mm                |
| 3     | 1/2       | 13   | 5300                       | 2409  | 8.625         | 219 | 17              | 432  | 18               | 457 | 7             | 768                | 234 | 18                        | 457 | 42                        | 1067 <sup>1</sup> |
| 3     | 9/16      | 14   | 6000                       | 2722  | 9.750         | 248 | 17              | 432  | 18               | 457 | 5             | 505                | 154 | 18                        | 457 | 42                        | 1067 <sup>1</sup> |
| 4     | 5/8       | 16   | 8200                       | 3727  | 10.750        | 273 | 22              | 559  | 24               | 610 | 8             | 1216               | 371 | 18                        | 457 | 48                        | 1219              |
| 4     | 3/4       | 19   | 9200                       | 4181  | 14.000        | 356 | 22              | 559  | 24               | 610 | 4             | 548                | 167 | 18                        | 457 | 48                        | 1219              |
| 5     | 7/8       | 22   | 14100                      | 6409  | 16.000        | 406 | 28              | 711  | 24               | 610 | 6             | 873                | 266 | 18                        | 457 | 48                        | 1219              |
| 5     | 1         | 25.4 | 16400                      | 7455  | 18.000        | 457 | 28              | 711  | 24               | 610 | 4             | 526                | 160 | 18                        | 457 | 48                        | 1219              |
| 6     | 1 1/8     | 29   | 21300                      | 9682  | 20.000        | 508 | 34              | 864  | 24               | 610 | 6             | 845                | 258 | 18                        | 457 | 48                        | 1219              |
| 7     | 1 1/4     | 32   | 27000                      | 12273 | 24.000        | 610 | 38              | 965  | 24               | 610 | 5             | 715                | 218 | 18                        | 457 | 48                        | 1219              |
| 7     | 1 3/8     | 35   | 32600                      | 14818 | 24.000        | 610 | 38              | 965  | 24               | 610 | 4             | 505                | 154 | 18                        | 457 | 48                        | 1219              |
| 8     | 1 1/2     | 38   | 42400                      | 19273 | 26.000        | 660 | 45              | 1143 | 30               | 762 | 6             | 1033               | 315 | 24                        | 610 | 60                        | 1524              |

<sup>1</sup> For drum layers longer than standard contact Technical Sales

**NEW!**

# Fulcrum Winch

200 to 50000 lb (91 to 22680 kg) capacity



### Specifications:

| Rope size<br>in. mm | Pulling winches, 1st layer |                         |                      |                         | Lifting winches, 1st layer |                         |                      |                         |           |
|---------------------|----------------------------|-------------------------|----------------------|-------------------------|----------------------------|-------------------------|----------------------|-------------------------|-----------|
|                     | rated load<br>lbs kg       | line speed<br>fpm m/min | rated load<br>lbs kg | line speed<br>fpm m/min | rated load<br>lbs kg       | line speed<br>fpm m/min | rated load<br>lbs kg | line speed<br>fpm m/min |           |
| <b>Frame 3</b>      |                            |                         |                      |                         |                            |                         |                      |                         |           |
| 1/2 13              | 5300 2409                  | 18 5.5                  | 5300 2409            | 18 5.5                  | 5300 2409                  | 28 8.5                  | 5300 2409            | 28 8.5                  | 5300 2409 |
| 1/2 13              | 5300 2409                  | 28 8.5                  | 5300 2409            | 28 8.5                  | 5300 2409                  | 39 11.9                 | 5300 2409            | 39 11.9                 | 5300 2409 |
| 1/2 13              | 5300 2409                  | 39 11.9                 | 5300 2409            | 39 11.9                 | 5300 2409                  | 59 18.0                 | 5300 2409            | 59 18.0                 | 5300 2409 |
| 1/2 13              | 5300 2409                  | 59 18.0                 | 5300 2409            | 59 18.0                 | 5300 2409                  | 86 26.2                 | 5300 2409            | 86 26.2                 | 5300 2409 |
| 1/2 13              | 5300 2409                  | 86 26.2                 | 5300 2409            | 86 26.2                 | 5300 2409                  | 101 30.8                | 5300 2409            | 101 30.8                | 5300 2409 |
| 9/16 14             | 6700 3045                  | 23 7.0                  | 6000 2727            | 25 7.6                  | 6000 2727                  | 34 10.4                 | 6000 2727            | 38 11.6                 | 6000 2727 |
| 9/16 14             | 6700 3045                  | 34 10.4                 | 6000 2727            | 38 11.6                 | 6000 2727                  | 48 14.6                 | 6000 2727            | 53 16.2                 | 6000 2727 |
| 9/16 14             | 6700 3045                  | 48 14.6                 | 6000 2727            | 53 16.2                 | 6000 2727                  | 69 21.0                 | 6000 2727            | 77 23.5                 | 6000 2727 |
| 9/16 14             | 6700 3045                  | 69 21.0                 | 6000 2727            | 77 23.5                 | 6000 2727                  | 87 26.5                 | 6000 2727            | 97 29.6                 | 6000 2727 |
| 9/16 14             | 6700 3045                  | 87 26.5                 | 6000 2727            | 97 29.6                 | 6000 2727                  | 102 31.1                | 6000 2727            | 114 34.7                | 6000 2727 |
| 9/16 14             | 6700 3045                  | 102 31.1                | 6000 2727            | 114 34.7                | 6000 2727                  |                         |                      |                         |           |
| <b>Frame 4</b>      |                            |                         |                      |                         |                            |                         |                      |                         |           |
| 5/8 16              | 8200 3727                  | 11 3.4                  | 8200 3727            | 11 3.4                  | 8200 3727                  | 19 5.8                  | 8200 3727            | 19 5.8                  | 8200 3727 |
| 5/8 16              | 8200 3727                  | 19 5.8                  | 8200 3727            | 19 5.8                  | 8200 3727                  | 24 7.3                  | 8200 3727            | 24 7.3                  | 8200 3727 |
| 5/8 16              | 8200 3727                  | 24 7.3                  | 8200 3727            | 24 7.3                  | 8200 3727                  | 38 11.6                 | 8200 3727            | 38 11.6                 | 8200 3727 |
| 5/8 16              | 8200 3727                  | 38 11.6                 | 8200 3727            | 38 11.6                 | 8200 3727                  | 54 16.5                 | 8200 3727            | 54 16.5                 | 8200 3727 |
| 5/8 16              | 8200 3727                  | 54 16.5                 | 8200 3727            | 54 16.5                 | 8200 3727                  | 79 24.1                 | 8200 3727            | 79 24.1                 | 8200 3727 |
| 5/8 16              | 8200 3727                  | 79 24.1                 | 8200 3727            | 79 24.1                 | 8200 3727                  | 99 30.2                 | 8200 3727            | 99 30.2                 | 8200 3727 |
| 5/8 16              | 8200 3727                  | 99 30.2                 | 8200 3727            | 99 30.2                 | 8200 3727                  | 117 35.7                | 8200 3727            | 117 35.7                | 8200 3727 |
| 5/8 16              | 8200 3727                  | 117 35.7                | 8200 3727            | 117 35.7                | 8200 3727                  |                         |                      |                         |           |
| 3/4 19              | 11700 5318                 | 14 4.3                  | 9200 4181            | 18 5.5                  | 9200 4181                  | 20 6.1                  | 9200 4181            | 25 7.6                  | 9200 4181 |
| 3/4 19              | 11700 5318                 | 20 6.1                  | 9200 4181            | 25 7.6                  | 9200 4181                  | 25 7.6                  | 9200 4181            | 31 9.5                  | 9200 4181 |
| 3/4 19              | 11700 5318                 | 25 7.6                  | 9200 4181            | 31 9.5                  | 9200 4181                  | 46 14.0                 | 9200 4181            | 58 17.7                 | 9200 4181 |
| 3/4 19              | 11700 5318                 | 46 14.0                 | 9200 4181            | 58 17.7                 | 9200 4181                  | 55 16.8                 | 9200 4181            | 70 21.3                 | 9200 4181 |
| 3/4 19              | 11700 5318                 | 55 16.8                 | 9200 4181            | 70 21.3                 | 9200 4181                  | 64 19.5                 | 9200 4181            | 81 24.7                 | 9200 4181 |
| 3/4 19              | 11700 5318                 | 64 19.5                 | 9200 4181            | 81 24.7                 | 9200 4181                  | 81 24.7                 | 9200 4181            | 103 31.4                | 9200 4181 |
| 3/4 19              | 11700 5318                 | 81 24.7                 | 9200 4181            | 103 31.4                | 9200 4181                  | 101 30.8                | 9200 4181            | 128 39.0                | 9200 4181 |
| 3/4 19              | 11700 5318                 | 101 30.8                | 9200 4181            | 128 39.0                | 9200 4181                  |                         |                      |                         |           |

### Specifications:

| Rope size<br>in. mm | Pulling winches, 1st layer |                         |                      |                         | Lifting winches, 1st layer |                         |                      |                         |             |
|---------------------|----------------------------|-------------------------|----------------------|-------------------------|----------------------------|-------------------------|----------------------|-------------------------|-------------|
|                     | rated load<br>lbs kg       | line speed<br>fpm m/min | rated load<br>lbs kg | line speed<br>fpm m/min | rated load<br>lbs kg       | line speed<br>fpm m/min | rated load<br>lbs kg | line speed<br>fpm m/min |             |
| <b>Frame 5</b>      |                            |                         |                      |                         |                            |                         |                      |                         |             |
| 7/8 22              | 15900 7227                 | 21 6.4                  | 14100 6409           | 23 7.0                  | 15900 7227                 | 29 8.8                  | 14100 6409           | 32 10.0                 | 15900 7227  |
| 7/8 22              | 15900 7227                 | 29 8.8                  | 14100 6409           | 32 10.0                 | 15900 7227                 | 36 11.0                 | 14100 6409           | 40 12.2                 | 15900 7227  |
| 7/8 22              | 15900 7227                 | 36 11.0                 | 14100 6409           | 40 12.2                 | 15900 7227                 | 82 25.0                 | 14100 6409           | 92 28.0                 | 15900 7227  |
| 7/8 22              | 15900 7227                 | 82 25.0                 | 14100 6409           | 92 28.0                 | 15900 7227                 | 21 6.4                  | 16400 7455           | 26 7.9                  | 15900 7227  |
| 1 25.4              | 20600 9364                 | 21 6.4                  | 16400 7455           | 26 7.9                  | 20600 9364                 | 25 7.6                  | 16400 7455           | 31 9.5                  | 20600 9364  |
| 1 25.4              | 20600 9364                 | 25 7.6                  | 16400 7455           | 31 9.5                  | 20600 9364                 | 29 8.8                  | 16400 7455           | 36 11.0                 | 20600 9364  |
| 1 25.4              | 20600 9364                 | 29 8.8                  | 16400 7455           | 36 11.0                 | 20600 9364                 | 36 11.0                 | 16400 7455           | 46 14.0                 | 20600 9364  |
| 1 25.4              | 20600 9364                 | 36 11.0                 | 16400 7455           | 46 14.0                 | 20600 9364                 |                         |                      |                         |             |
| <b>Frame 6</b>      |                            |                         |                      |                         |                            |                         |                      |                         |             |
| 1 1/8 29            | 26000 11818                | 18 5.5                  | 21300 9682           | 22 6.7                  | 26000 11818                | 26 7.9                  | 21300 9682           | 32 10.0                 | 26000 11818 |
| 1 1/8 29            | 26000 11818                | 26 7.9                  | 21300 9682           | 32 10.0                 | 26000 11818                | 38 11.6                 | 21300 9682           | 47 14.3                 | 26000 11818 |
| 1 1/8 29            | 26000 11818                | 38 11.6                 | 21300 9682           | 47 14.3                 | 26000 11818                | 75 22.9                 | 21300 9682           | 91 27.7                 | 26000 11818 |
| 1 1/8 29            | 26000 11818                | 75 22.9                 | 21300 9682           | 91 27.7                 | 26000 11818                | 90 27.4                 | 21300 9682           | 110 33.5                | 26000 11818 |
| 1 1/8 29            | 26000 11818                | 90 27.4                 | 21300 9682           | 110 33.5                | 26000 11818                |                         |                      |                         |             |
| <b>Frame 7</b>      |                            |                         |                      |                         |                            |                         |                      |                         |             |
| 1 1/4 32            | 31900 14500                | 21 6.4                  | 27000 12273          | 24 7.3                  | 31900 14500                | 26 7.9                  | 27000 12273          | 31 9.5                  | 31900 14500 |
| 1 1/4 32            | 31900 14500                | 26 7.9                  | 27000 12273          | 31 9.5                  | 31900 14500                | 34 10.4                 | 27000 12273          | 40 12.2                 | 31900 14500 |
| 1 1/4 32            | 31900 14500                | 34 10.4                 | 27000 12273          | 40 12.2                 | 31900 14500                | 43 13.1                 | 27000 12273          | 51 15.5                 | 31900 14500 |
| 1 1/4 32            | 31900 14500                | 43 13.1                 | 27000 12273          | 51 15.5                 | 31900 14500                | 50 15.2                 | 27000 12273          | 59 18.0                 | 31900 14500 |
| 1 1/4 32            | 31900 14500                | 50 15.2                 | 27000 12273          | 59 18.0                 | 31900 14500                | 22 6.7                  | 32600 14818          | 25 7.6                  | 31900 14500 |
| 1 3/8 35            | 38400 17454                | 22 6.7                  | 32600 14818          | 25 7.6                  | 38400 17454                | 25 7.6                  | 32600 14818          | 29 8.8                  | 38400 17454 |
| 1 3/8 35            | 38400 17454                | 25 7.6                  | 32600 14818          | 29 8.8                  | 38400 17454                | 35 10.7                 | 32600 14818          | 41 12.5                 | 38400 17454 |
| 1 3/8 35            | 38400 17454                | 35 10.7                 | 32600 14818          | 41 12.5                 | 38400 17454                | 43 13.1                 | 32600 14818          | 51 15.5                 | 38400 17454 |
| 1 3/8 35            | 38400 17454                | 43 13.1                 | 32600 14818          | 51 15.5                 | 38400 17454                | 51 15.5                 | 32600 14818          | 60 18.3                 | 38400 17454 |
| 1 3/8 35            | 38400 17454                | 51 15.5                 | 32600 14818          | 60 18.3                 | 38400 17454                |                         |                      |                         |             |
| <b>Frame 8</b>      |                            |                         |                      |                         |                            |                         |                      |                         |             |
| 1 1/2 38            | 45600 20727                | 21 6.4                  | 42400 19273          | 23 7.0                  | 45600 20727                | 31 9.5                  | 42400 19273          | 33 10.1                 | 45600 20727 |
| 1 1/2 38            | 45600 20727                | 31 9.5                  | 42400 19273          | 33 10.1                 | 45600 20727                | 37 11.3                 | 42400 19273          | 39 11.9                 | 45600 20727 |
| 1 1/2 38            | 45600 20727                | 37 11.3                 | 42400 19273          | 39 11.9                 | 45600 20727                | 47 14.3                 | 42400 19273          | 50 15.2                 | 45600 20727 |
| 1 1/2 38            | 45600 20727                | 47 14.3                 | 42400 19273          | 50 15.2                 | 45600 20727                |                         |                      |                         |             |

### Drum Lengths

| Models         |         | Standard Drum Length |     | Optional Drum length |      |     |      |
|----------------|---------|----------------------|-----|----------------------|------|-----|------|
| Pulling        | Lifting | in.                  | mm  | in.                  | mm   | in. | mm   |
| <b>Frame 3</b> |         |                      |     |                      |      |     |      |
| EP5300         | EL5300  | 18                   | 457 | 30                   | 762  | 42  | 1069 |
| EP6700         | EL6000  | 18                   | 457 | 30                   | 762  | 42  | 1069 |
| <b>Frame 4</b> |         |                      |     |                      |      |     |      |
| EP8200         | EL8200  | 24                   | 610 | 36                   | 914  | 48  | 1219 |
| EP11700        | EL9200  | 24                   | 610 | 36                   | 914  | 48  | 1219 |
| <b>Frame 5</b> |         |                      |     |                      |      |     |      |
| EP15900        | EL14100 | 24                   | 610 | 36                   | 914  | 48  | 1219 |
| EP20600        | EL16400 | 24                   | 610 | 36                   | 914  | 48  | 1219 |
| <b>Frame 6</b> |         |                      |     |                      |      |     |      |
| EP26000        | EL21300 | 24                   | 610 | 36                   | 914  | 48  | 1219 |
| <b>Frame 7</b> |         |                      |     |                      |      |     |      |
| EP31900        | EL27000 | 24                   | 610 | 36                   | 914  | 48  | 1219 |
| EP38400        | EL32600 | 24                   | 610 | 36                   | 914  | 48  | 1219 |
| <b>Frame 8</b> |         |                      |     |                      |      |     |      |
| EP45600        | EL42400 | 30                   | 762 | 42                   | 1069 | 54  | 1372 |

**NEW!**

# Fulcrum Winch

## 200 to 50000 lb (91 to 22680 kg) capacity



### Dimensions <sup>1</sup>

#### Pulling

| Frame | Model         | A   |     | B     |     | C    |     | D   |      | E    |      | F     |      | G   |    | H    |     | J    |     |
|-------|---------------|-----|-----|-------|-----|------|-----|-----|------|------|------|-------|------|-----|----|------|-----|------|-----|
|       |               | in. | mm  | in.   | mm  | in.  | mm  | in. | mm   | in.  | mm   | in.   | mm   | in. | mm | in.  | mm  | in.  | mm  |
| 3     | EP5300-18-18  | 18  | 457 | 8.63  | 219 | 4.19 | 106 | 17  | 432  | 23.5 | 597  | 29.54 | 737  | 0.5 | 13 | 23   | 584 | 15   | 381 |
| 3     | EP6700-23-18  | 18  | 457 | 8.63  | 219 | 4.19 | 106 | 17  | 432  | 23.5 | 597  | 29.54 | 737  | 0.5 | 13 | 23   | 584 | 15   | 381 |
| 4     | EP8200-19-24  | 24  | 610 | 10.75 | 273 | 5.63 | 143 | 22  | 559  | 28.5 | 711  | 40.54 | 1030 | 0.5 | 13 | 27.5 | 699 | 17.5 | 445 |
| 4     | EP11700-14-24 | 24  | 610 | 10.75 | 273 | 5.63 | 143 | 22  | 559  | 28.5 | 711  | 40.54 | 1030 | 0.5 | 13 | 27.5 | 699 | 17.5 | 445 |
| 5     | EP15900-21-24 | 24  | 610 | 14    | 357 | 7    | 178 | 28  | 711  | 33.5 | 851  | 42.5  | 1080 | 0.5 | 13 | 34.5 | 876 | 22.5 | 572 |
| 5     | EP20600-21-24 | 24  | 610 | 14    | 357 | 7    | 178 | 28  | 711  | 33.5 | 851  | 42.5  | 1080 | 0.5 | 13 | 34.5 | 876 | 22.5 | 572 |
| 6     | EP26000-18-24 | 24  | 610 | 16    | 406 | 9    | 229 | 34  | 864  | 42.5 | 1080 | 44.82 | 1138 | 0.5 | 13 | 38.5 | 978 | 25.5 | 648 |
| 7     | EP31900-21-24 | 24  | 610 | 20    | 508 | 9    | 229 | 38  | 965  | -    | -    | -     | -    | -   | -  | -    | -   | -    |     |
| 7     | EP38400-25-24 | 24  | 610 | 20    | 508 | 9    | 229 | 38  | 965  | -    | -    | -     | -    | -   | -  | -    | -   | -    |     |
| 8     | EP45600-21-30 | 30  | 762 | 24    | 610 | 10.5 | 267 | 45  | 1143 | -    | -    | -     | -    | -   | -  | -    | -   | -    |     |

<sup>1</sup> Dimensions are subject to change. Contact technical sales for certified prints.  
 Dimensions are for standard base models only.

### Dimensions <sup>1</sup>

#### Lifting

| Frame | Model         | A   |     | B1    |     | C    |     | D   |      | E    |      | F     |      | G   |    | H    |     | J    |     |
|-------|---------------|-----|-----|-------|-----|------|-----|-----|------|------|------|-------|------|-----|----|------|-----|------|-----|
|       |               | in. | mm  | in.   | mm  | in.  | mm  | in. | mm   | in.  | mm   | in.   | mm   | in. | mm | in.  | mm  | in.  | mm  |
| 3     | EL5300-18-18  | 18  | 457 | 8.63  | 219 | 4.19 | 106 | 17  | 432  | 23.5 | 597  | 29.54 | 737  | 0.5 | 13 | 23   | 584 | 15   | 381 |
| 3     | EL6700-25-18  | 18  | 457 | 9.75  | 248 | 3.63 | 92  | 17  | 432  | 23.5 | 597  | 29.54 | 737  | 0.5 | 13 | 23   | 584 | 15   | 381 |
| 4     | EL8200-19-24  | 24  | 610 | 10.75 | 273 | 5.63 | 143 | 22  | 559  | 28.5 | 711  | 40.54 | 1030 | 0.5 | 13 | 27.5 | 699 | 17.5 | 445 |
| 4     | EL9200-18-24  | 24  | 610 | 14    | 357 | 4    | 102 | 22  | 559  | 28.5 | 711  | 40.54 | 1030 | 0.5 | 13 | 27.5 | 699 | 17.5 | 445 |
| 5     | EL14100-23-24 | 24  | 610 | 16    | 406 | 6    | 152 | 28  | 711  | 33.5 | 851  | 42.5  | 1080 | 0.5 | 13 | 34.5 | 876 | 22.5 | 572 |
| 5     | EL16400-26-24 | 24  | 610 | 18    | 457 | 5    | 127 | 28  | 711  | 33.5 | 851  | 42.5  | 1080 | 0.5 | 13 | 34.5 | 876 | 22.5 | 572 |
| 6     | EL21300-22-24 | 24  | 610 | 20    | 508 | 7    | 179 | 34  | 864  | 42.5 | 1080 | 44.82 | 1138 | 0.5 | 13 | 38.5 | 978 | 25.5 | 648 |
| 7     | EL27000-24-24 | 24  | 610 | 24    | 610 | 7    | 179 | 38  | 965  | -    | -    | -     | -    | -   | -  | -    | -   | -    |     |
| 7     | EL32600-29-24 | 24  | 610 | 24    | 610 | 7    | 179 | 38  | 965  | -    | -    | -     | -    | -   | -  | -    | -   | -    |     |
| 8     | EL42400-23-30 | 30  | 762 | 26    | 660 | 9.5  | 241 | 45  | 1143 | -    | -    | -     | -    | -   | -  | -    | -   | -    |     |

<sup>1</sup> Dimensions are subject to change. Contact technical sales for certified prints.  
 Dimensions are for standard base models only.

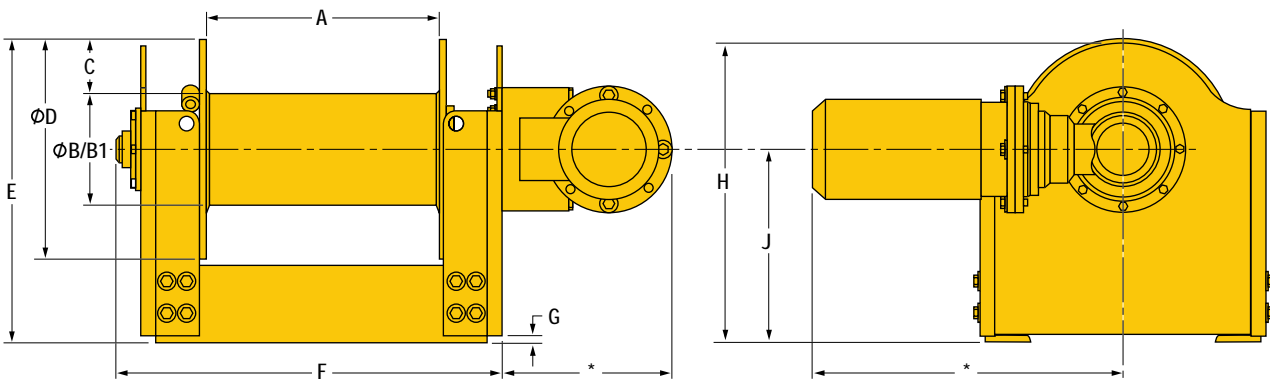

**NEW!**

# Fulcrum Winch

200 to 50000 lb (91 to 22680 kg) capacity



### How to Order:

Specify the complete model as shown. **Example: EL5300-28-18-8G-M4-P4-20** is an electric powered lifting winch with a 5300 lb capacity, a 28 fpm line speed, an 18 inch drum, 460-3-60 volt, with grooved drum, NEMA 4 starter and pushbutton, and 20 feet of control cord.

| Series   | Application  | Capacity          | Line speed        | Drum length                       | Voltage  | Winch options   | Starter/drives   | Control station   | Cord length (ft) |
|--|--|-------------------|-------------------|-----------------------------------|--|---|--|---|------------------|
| <b>E</b>   | <b>L</b>   | <b>5300</b>       | <b>28</b>         | <b>18</b>                         | <b>8</b>   | <b>G</b>  | <b>M4</b>  | <b>P4</b>   | <b>20</b>        |
| <b>E</b> = Electric<br><b>H</b> = Hydraulic <sup>3</sup> | <b>L</b> = Lifting<br><b>P</b> = Pulling<br><b>MR</b> = Electric Manrider <sup>3</sup> | (See table below) | (See table below) | (See std. drum width chart below) | <b>1</b> = 115-1-60<br><b>2</b> = 230-1-60<br><b>3</b> = 208-3-60<br><b>4</b> = 230-3-60<br><b>5</b> = 380-3-50<br><b>6</b> = 400-3-50<br><b>7</b> = 415-3-50<br><b>8</b> = 460-3-60<br><b>9</b> = 575-3-60<br><b>0</b> = Used w/hydraulic and air units | <b>A</b> = Air operated drum brake<br><b>C</b> = Special motor per customer specs<br><b>D</b> = Drum divider flange; <b>X</b> = no. of dividers<br><b>F</b> = Free-spooling clutch<br><b>G</b> = Grooved drum <sup>(3)</sup><br><b>H</b> = Horizontal load reversing drum <sup>(4)</sup><br><b>J</b> = Space heater in motor<br><b>K</b> = Hand crank for emergency manual operation<br><b>L</b> = Drum locking pin<br><b>M</b> = Marine duty, IEEEE45 motor<br><b>N</b> = Mirror image unit<br><b>P</b> = Marine 812 finish<br><b>Q</b> = Special paint; please specify<br><b>R</b> = Press roller on drum<br><b>S</b> = NEMA 4 upper & lower, rotary limit switch<br><b>T</b> = Dual speed motor<br><b>U</b> = Manual level wind<br><b>W</b> = Slack rope detector<br><b>X</b> = Drum guard<br><b>Y</b> = Electronic overload limiter<br><b>Z</b> = Sandblast / carbozinc | <b>M4</b> = NEMA 4 starter<br><b>M4X</b> = NEMA 4X starter<br><b>V</b> = Variable frequency drive. Customer to specify control requirements.<br><b>X</b> = Explosion-proof starter. Customer to specify class, division and group. | <b>D1</b> = Drum switch NEMA 1<br><b>D4</b> = Drum switch NEMA 4<br><b>E</b> = Explosion-proof controller. Customer to specify class, division and group.<br><b>P4</b> = Pushbutton NEMA 4<br><b>P4X</b> = Pushbutton NEMA 4X<br><b>W1</b> = Wall mount pushbutton station, NEMA 1<br><b>W4</b> = Wall mount pushbutton station, NEMA 4 |                  |

### First layer capacities

| Frame    | Pulling capacities             | Line speeds / fpm <sup>(1)</sup> | Lifting capacities             | Line speeds speeds / fpm <sup>(1)</sup> | Std. drum width <sup>(2)</sup> |
|----------|--------------------------------|----------------------------------|--------------------------------|---|--------------------------------|
| <b>3</b> | <b>EP</b> 5300 lbs / 2409 kg   | 18, 28, 39, 59, 86, 101          | <b>EL</b> 5300 lbs / 2409 kg   | 18, 28, 39, 59, 86, 101                 | 18 in. / 457 mm                |
| <b>3</b> | <b>EP</b> 6700 lbs / 3045 kg   | 23, 34, 48, 69, 87, 102          | <b>EL</b> 6000 lbs / 2727 kg   | 25, 38, 53, 77, 97, 114                 | 18 in. / 457 mm                |
| <b>4</b> | <b>EP</b> 8200 lbs / 3727 kg   | 11, 19, 24, 38, 54, 79, 99, 117  | <b>EL</b> 8200 lbs / 3727 kg   | 11, 19, 24, 38, 54, 79, 99, 117         | 24 in. / 610 mm                |
| <b>4</b> | <b>EP</b> 11700 lbs / 5318 kg  | 14, 20, 25, 46, 55, 64, 81, 101  | <b>EL</b> 9200 lbs / 4181 kg   | 18, 25, 31, 58, 70, 81, 103, 128        | 24 in. / 610 mm                |
| <b>5</b> | <b>EP</b> 15900 lbs / 7227 kg  | 21, 29, 36, 82                   | <b>EL</b> 14100 lbs / 6409 kg  | 23, 32, 40, 92                          | 24 in. / 610 mm                |
| <b>5</b> | <b>EP</b> 20600 lbs / 9364 kg  | 21, 25, 29, 36                   | <b>EL</b> 16400 lbs / 7455 kg  | 26, 31, 36, 46                          | 24 in. / 610 mm                |
| <b>6</b> | <b>EP</b> 26000 lbs / 11818 kg | 18, 26, 38, 75, 90               | <b>EL</b> 21300 lbs / 9682 kg  | 22, 32, 47, 91, 110                     | 24 in. / 610 mm                |
| <b>7</b> | <b>EP</b> 31900 lbs / 14500 kg | 21, 26, 34, 43, 50               | <b>EL</b> 27000 lbs / 12273 kg | 24, 31, 40, 51, 59                      | 24 in. / 610 mm                |
| <b>7</b> | <b>EP</b> 38400 lbs / 17455 kg | 22, 25, 35, 43, 51               | <b>EL</b> 32600 lbs / 14818 kg | 25, 29, 41, 51, 60                      | 24 in. / 610 mm                |
| <b>8</b> | <b>EP</b> 45600 lbs / 20727 kg | 21, 31, 37, 47                   | <b>EL</b> 42400 lbs / 19273 kg | 23, 33, 39, 50                          | 30 in. / 762 mm                |

- (1) First layer line speed
- (2) Other drum lengths available
- (3) Grooving is based on left hand spiral for overwind take-off. The size of the grooving is based on the recommended wire rope size specified for each frame and is selected to meet ANSI / ASME B30.7 recommendations. If different size grooving is required it must be specified by enduser at time of order.
- (4) Wire rope size and cable take-offs must be specified at time of an order.